



## Customer Case Study

# Furfari Paving Co Ltd | Payables Time Tracking Solution

[www.ahearn.com](http://www.ahearn.com)



**Furfari Paving** is a family owned business that started back in 1962, and the business has grown from 6 to 90 million in a very short time. Furfari is a manufacturer, supplier and installer of Hot Mix Asphalt. Their customer base includes developers, municipalities and various transportation companies across the GTA. They currently employ 85 personnel and operate 3 asphalt manufacturing plants in Markham, Mississauga and Barrie, Ontario.

### Furfari's 'old' Process

Early 2009 the company General Manager approached Ahearn & Soper Inc. looking for a solution that would help them improve control and have a better understanding of payables to their haulage contractors. On any given day during a very busy paving season, Furfari could have up to 80 trucks picking up material from one of their three manufacturing plants to be delivered to an active job site anywhere within the vicinity. Foremen from various sites would have to manually collect and sign **hundreds of bill book tickets weekly** indicating the in/out time and job location for the many trucks around the City, keeping in mind that these trucks (in operation) are employed with various contracted companies. The signed tickets would then be returned to the main office where they were manually entered into a payables accounting system. Countless number of hours were spent entering data and fixing hand-written mistakes.

### Furfari's Pain Points ...

- Foremen signing and collecting countless numbers of pay slips by the end of each week
- Hours of manual entry of time slip information into a payables accounting system
- Significant delays in processing payments to haulage partners
- Data slips that were unreadable and impossible to validate, getting lost, or not being submitted at all
- Easy manipulation of time slips, etc.

License Plate	Asset ID	Company Name	Model	Truck Number	Created By	Created Date	Status
961 AUB	10003	Das-Mech Transport Inc.	Tractor	727		5/20/2009 3:49 PM	Active
167 AHD	10007	Das-Mech Transport Inc.	Tractor	765		5/20/2009 3:49 PM	Active
167 SHD	10008	Das-Mech Transport Inc.	Tractor	713		5/20/2009 3:49 PM	Active
908 ATE	10009	Das-Mech Transport Inc.	Tractor	834		5/20/2009 3:49 PM	Active
904 FRR	10010	Das-Mech Transport Inc.	Tractor	726		5/20/2009 3:49 PM	Active
909 DAV	10011	Das-Mech Transport Inc.	Tractor	772		5/20/2009 3:49 PM	Active
909 ATE	10012	Das-Mech Transport Inc.	Tractor	708		5/20/2009 3:49 PM	Active
711 BNB	10002	Das-Mech Transport Inc.	Tractor	739		5/20/2009 3:49 PM	Active
419 DHD	10003	Das-Mech Transport Inc.	Tractor	846		5/20/2009 3:49 PM	Active
434 BND	10004	Das-Mech Transport Inc.	Tractor	833		5/20/2009 3:49 PM	Active
546 ZPF	10005	Das-Mech Transport Inc.	Tractor	705		5/20/2009 3:49 PM	Active
614 TFM	10006	Das-Mech Transport Inc.	Tractor	781		5/20/2009 3:49 PM	Active
619 TR	10004	Defina Haulage Ltd.	Tractor	102		5/20/2009 3:49 PM	Active
662 SBL	10005	Defina Haulage Ltd.	Tractor	88		5/20/2009 3:49 PM	Active
560 TMM	10003	Defina Haulage Ltd.	Tractor	111		5/20/2009 3:49 PM	Active
518 ATE	10001	Defina Haulage Ltd.	Tractor	86		5/20/2009 3:49 PM	Active
518 BFI	10002	Defina Haulage Ltd.	Tractor	100		5/20/2009 3:49 PM	Active

### Ahearn Challenges ...

- Find a device that fits the field Supervisor's needs
- Define a solution architecture that fits their in-house IT expertise
- Build a custom application that targets their specific needs
- Design effective and user-friendly screens and work flow patterns
- Design bar coded truck asset ID cards

### Ahearn Solution ...

An Ahearn designed-and-supplied solution, delivered centralized data management of all payable transactions collected, using time tracking software at all 3 plants and 10 mobile sites. The Intermec mobile devices are rugged outdoor data collection terminals with integrated cellular

radios, and scanning equipment for the scanning of the truck asset cards. These mobile devices can perform in/out transactions in the field and communicate this information back to the central database using GSM radios, allowing the Supervisors to remain in the field while synchronizing the data.

The three plant locations are live to the central database at all times allowing in/out transactions to be inserted immediately. The Administrators in the main office have the ability to add or remove new truck assets, update active job site location information, and report on completed time transactions. All incomplete time transactions are marked as 'exceptions' for quick reviewing and updating.



**Note:** Ahearn and Soper Inc. provide remote monitoring and technical support to the customer's plant and supervisors.



## Customer Case Study

# Furfari Paving Co Ltd | Payables Time Tracking Solution

[www.ahearn.com](http://www.ahearn.com)

Look to **Ahearn & Soper** for ...

*Professional Services Made Simple!*

Our Professional Services Group (PSG) of Solution Designers, Developers and Integrators will help you get your project up and running smoothly and efficiently ... **ON TIME AND ON BUDGET!**

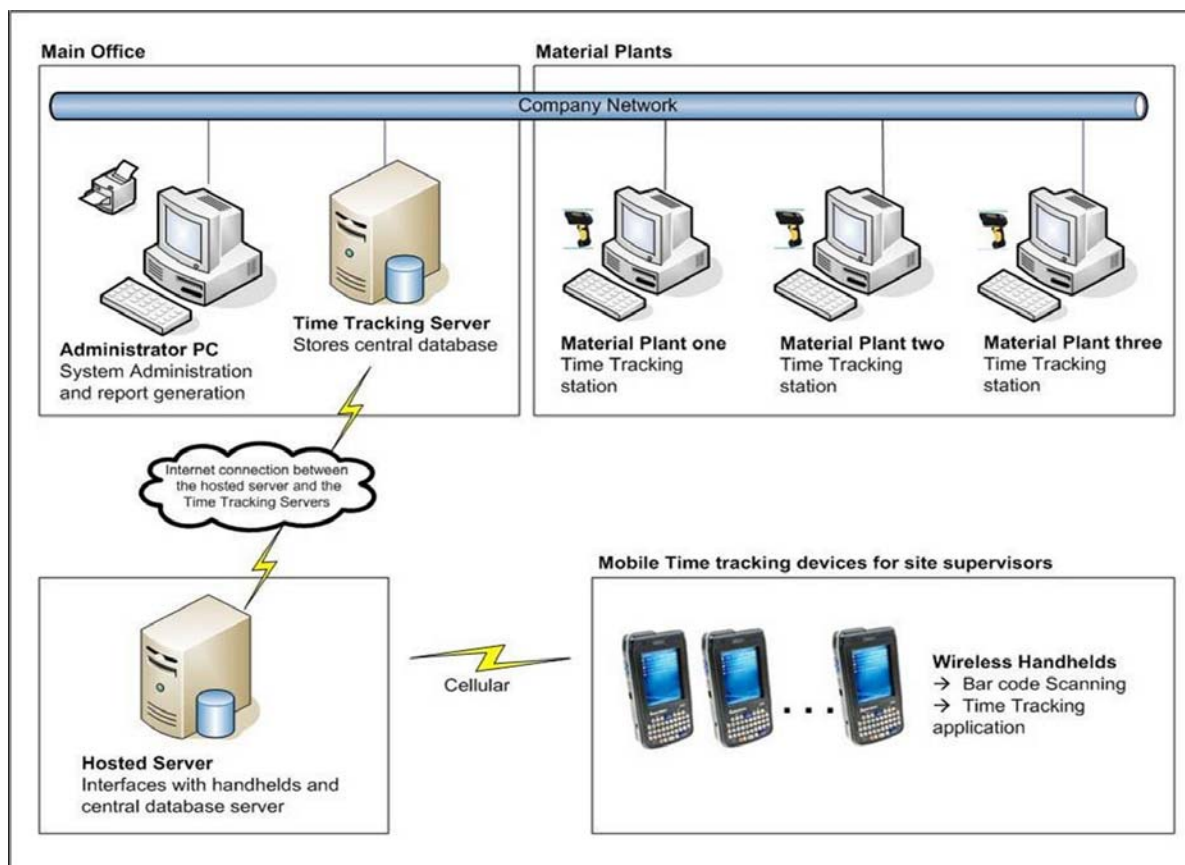

### Office Locations

**Toronto:** 100 Woodbine Downs Boulevard | Toronto, ON | M9W 5S6 | 800-263-4258

**Cambridge:** 380 Jamieson Parkway, Unit 4 | Cambridge, ON | N3C 4N4 | 519-885-2260

**Ottawa:** 38 Antares Drive, Suite 110 | Ottawa, ON | K2E 7V2 | 613-226-4520

**Montreal:** 3375 Rue Griffith | St.-Laurent, QC | H4T 1W5 | 800-361-9584

**Calgary:** Sales and Service | 800-468-7025 | 403-291-0300

**Edmonton:** Sales and Service | 800-468-7025 | 780-643-7444

**Vancouver:** Field Service Only | 800-468-7025

**Microsoft**  
GOLD CERTIFIED  
Partner

